

GREEN STUFF INDUSTRIES

Underground Hangar

10mm Scale

Kit Number: UNHA-10mm

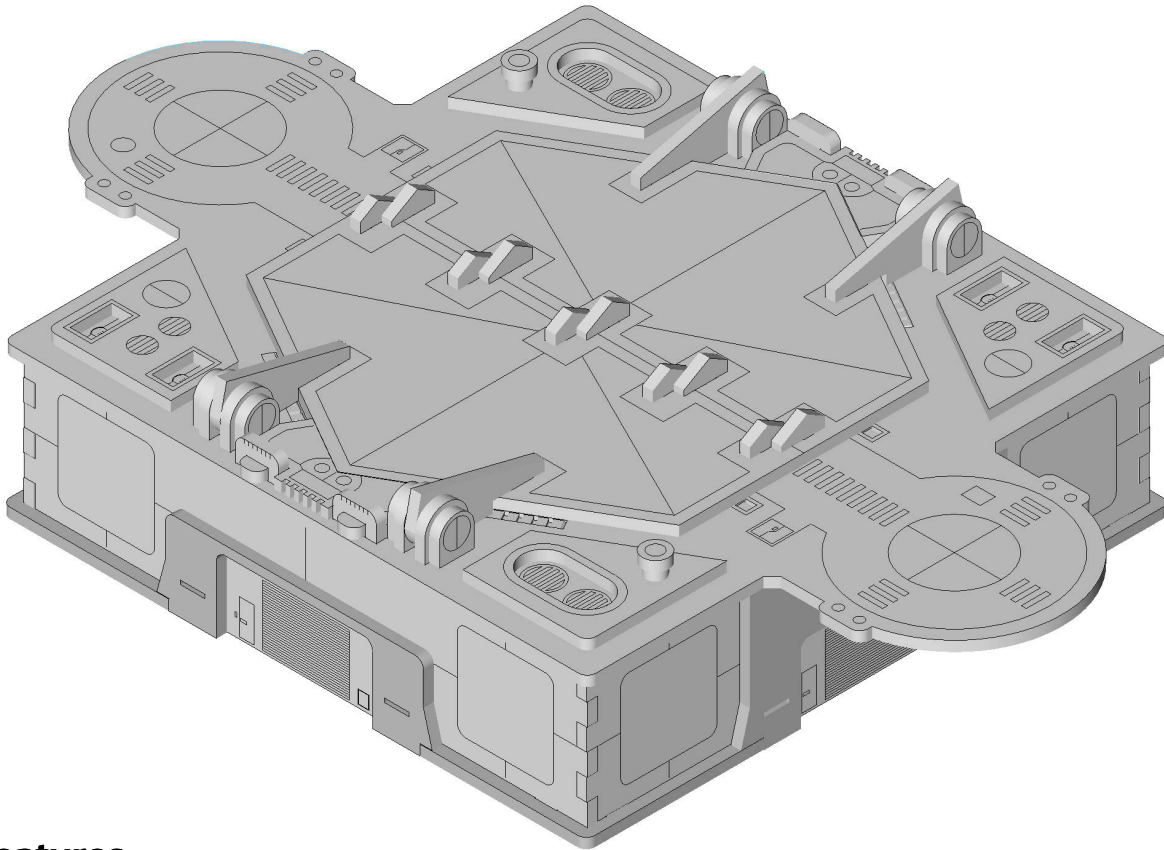

Features

- Infinity mirror creates the illusion of a 32 story deep hangar beneath your table!
- Electronics come pre-assembled and ready to install.
- Lights with a simple slide switch on the bottom of the model.
- Roof can be removed to access the battery area and clean the mirrors easily.
- Roof latches can be magnetized if desired.
- Mirror assembly can be removed and completely disassembled for cleaning.
- Elevator plate included.
- 2 auxiliary landing pads.
- Interlocking moving doors.
- Sensor dome and RADAR panel included , but are optional assembly steps.
- Excellent detail with sturdy construction.

Assembly required and 9v Battery not included. Small parts/choking hazard!

Direct questions or comments regarding this kit to: www.greenstuffindustries.com/contact

DESCRIPTION: This amazing kit provides the illusion of 16 levels of subterranean elevator! Each level of this kit is roughly 2 stories high in 10mm scale, creating an illusion that stretches down 32 stories into your gaming experience! The kit has a footprint of about 11" (280mm) by 6.5" (165mm) and is approximately 3.25" (83mm) high at its highest point with the doors closed. Open the doors and the kit becomes 5" (127mm) tall! This kit is designed to be used with Dropzone Commander by Hawk Wargames but would be an excellent addition to any 6-15mm battlefield.

Read the instructions thoroughly and carefully before beginning!

TO ASSEMBLE THIS KIT YOU WILL NEED...

- A hobby knife
- Fine grit sandpaper
- Polyvinyl Acetate (PVA) glue
- Four pieces of 8x1mm paper clip steel
- A small Phillips-head screwdriver and pliers

The following items will be helpful but are not required...

- Rubber bands for holding parts together
- Some small clamps

PAINTING ADVICE

Paint the inner walls of the shaft white before putting together the mirror assembly (page 8).

As the kit is made to come apart into three large assemblies, the top and base can be painted separately while the mirror assembly is not

IMPORTANT: Do Not use spray paint on the sensor dome (ping pong ball) as it may melt the cellulose. If you must use aerosol spray paint, thoroughly hand/airbrush the sphere first with Acrylic paint and then feel free to spray paint.

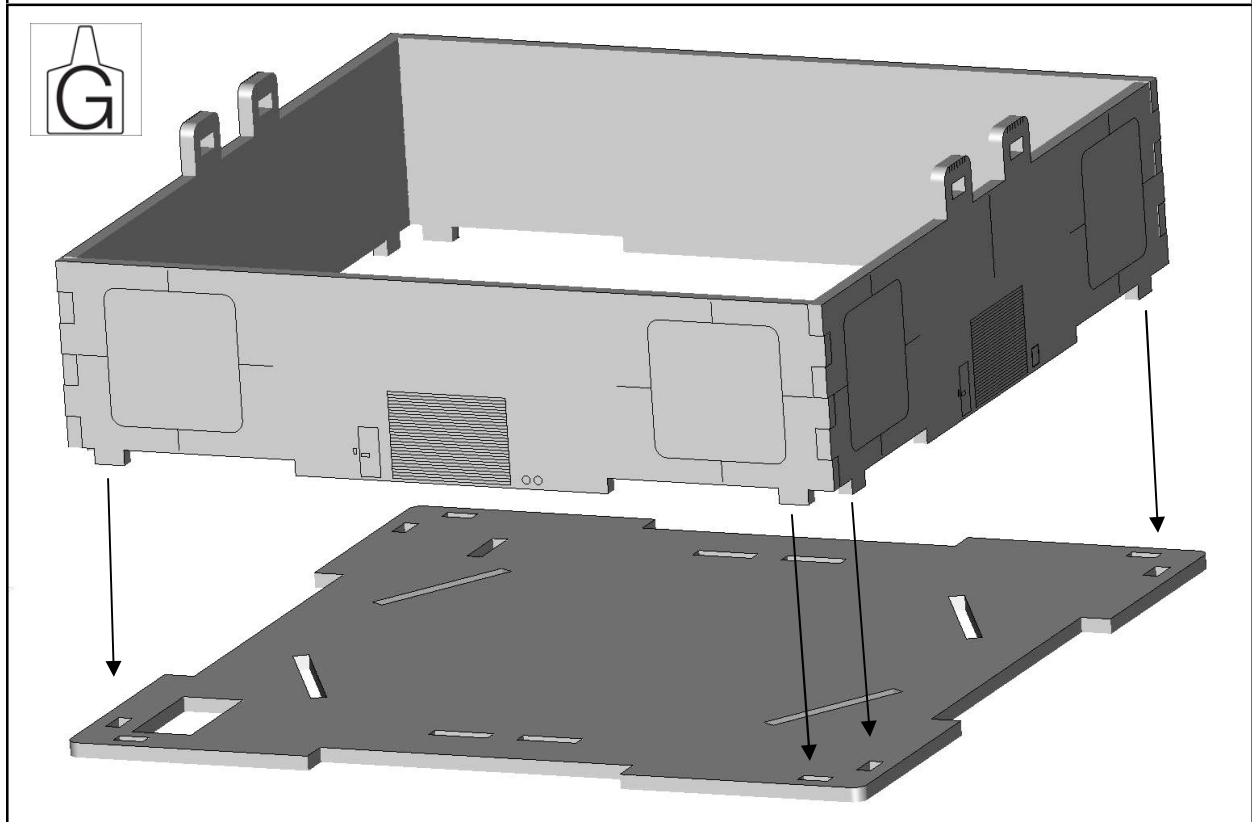
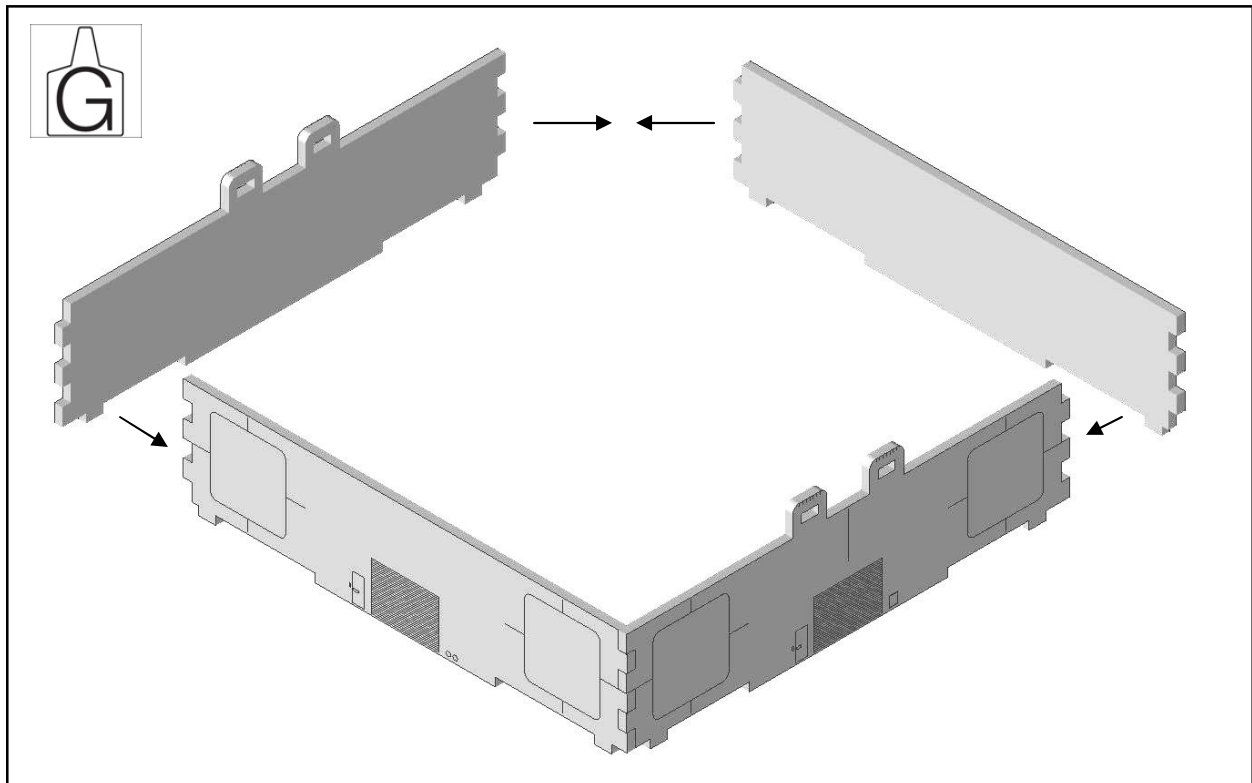

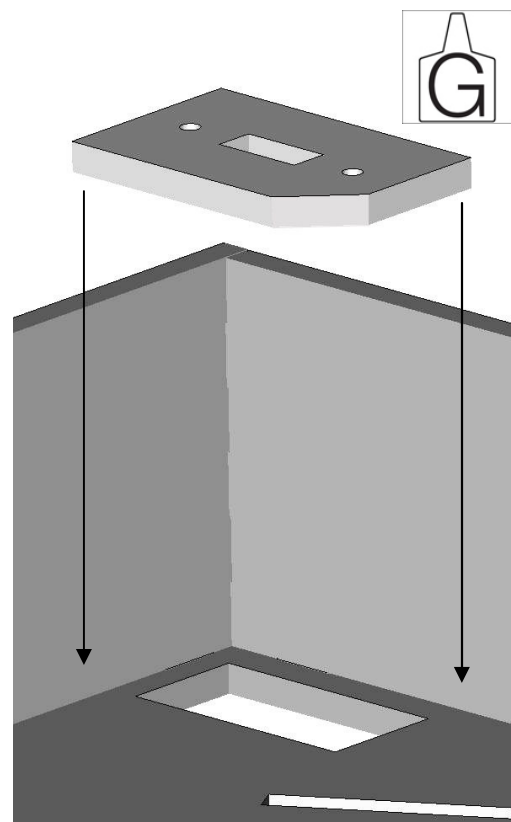
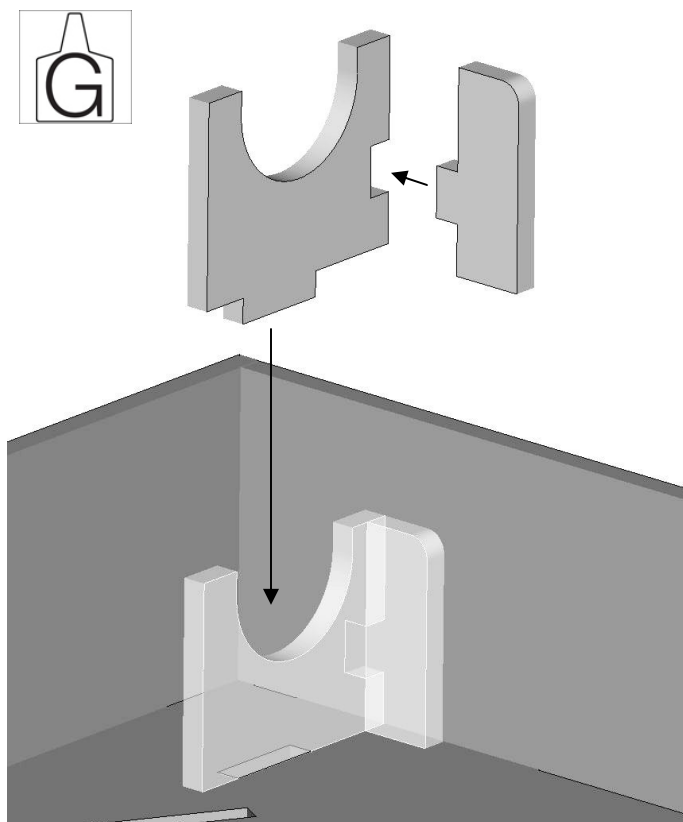
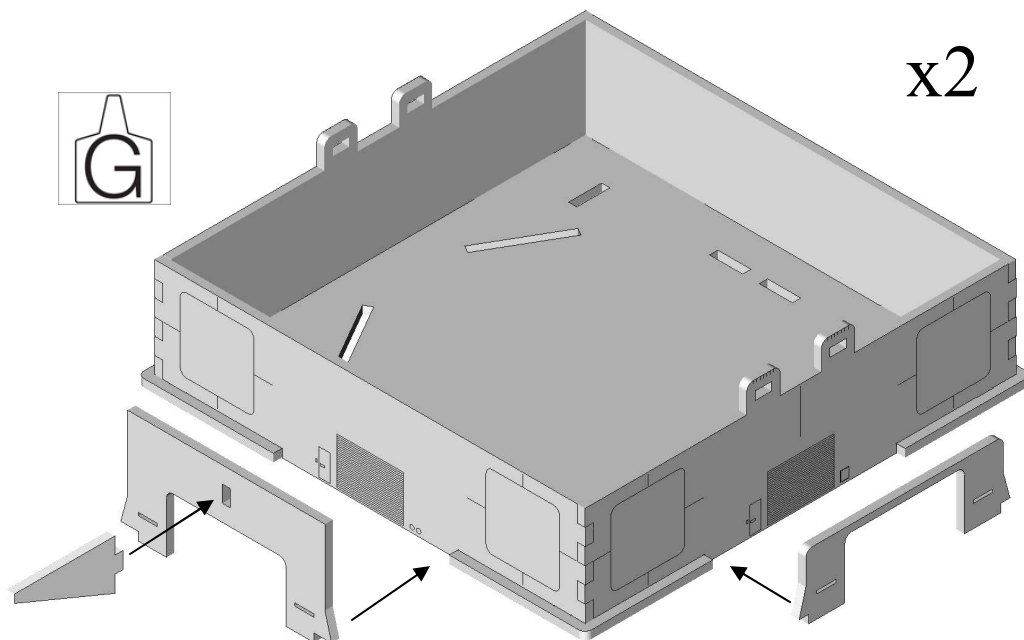

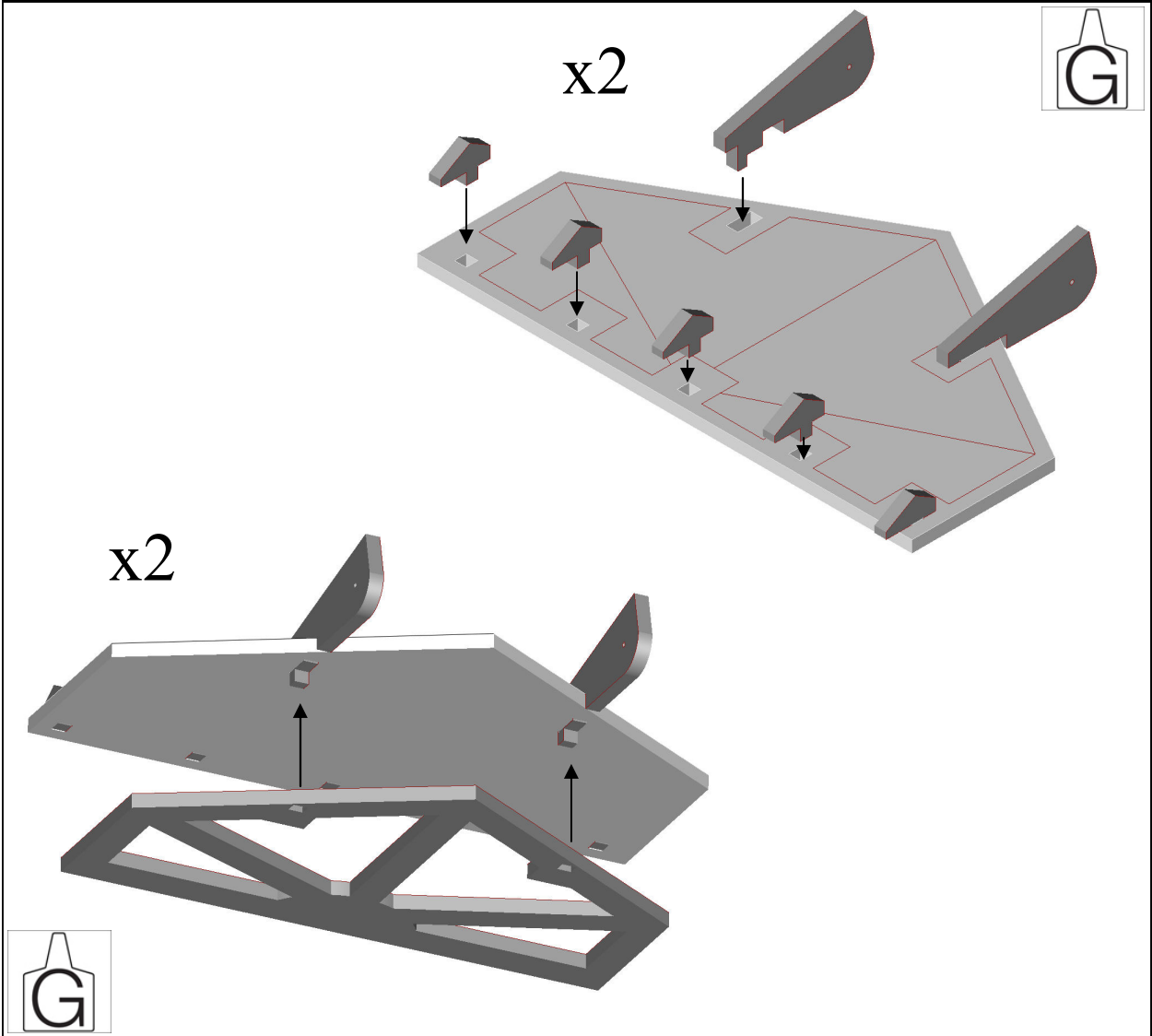
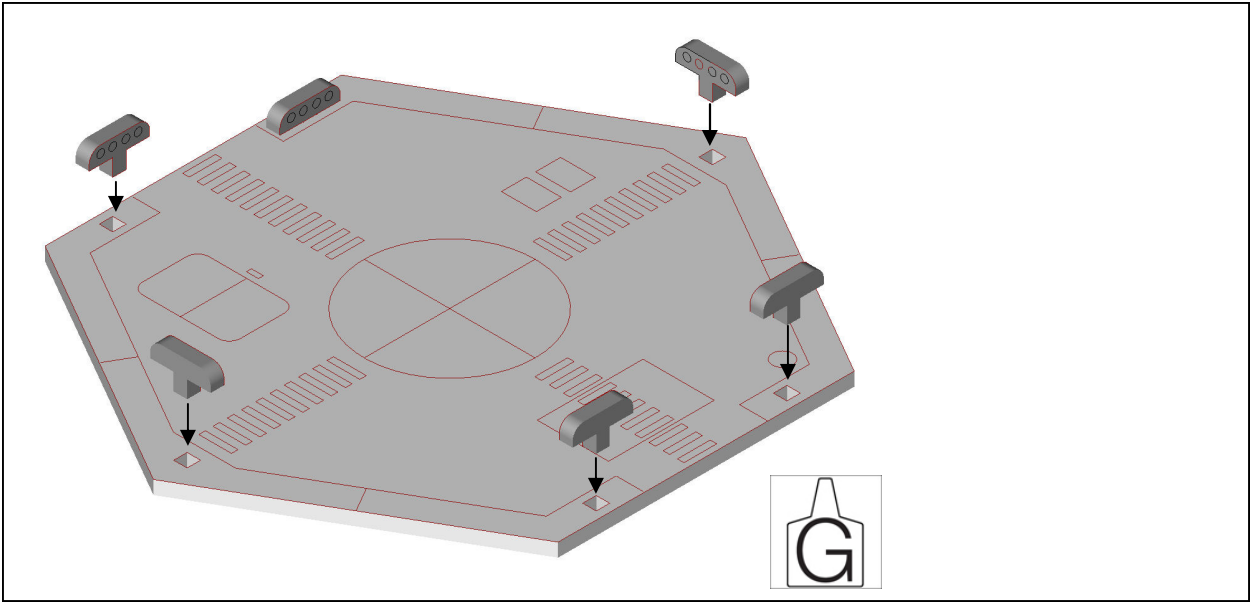

x2

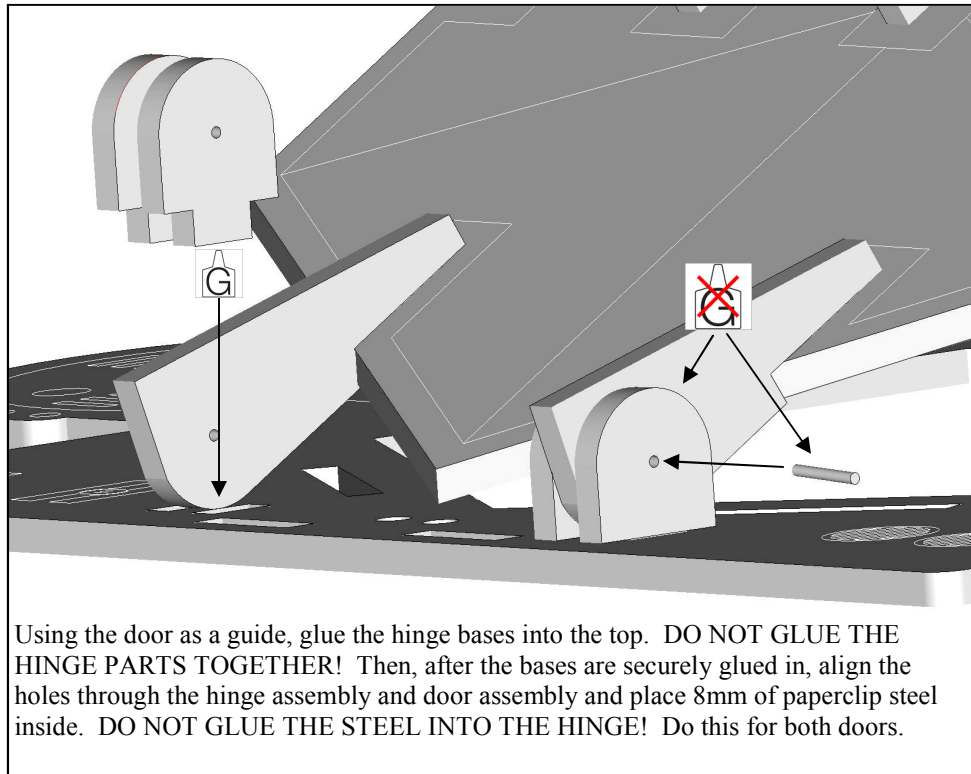

x4

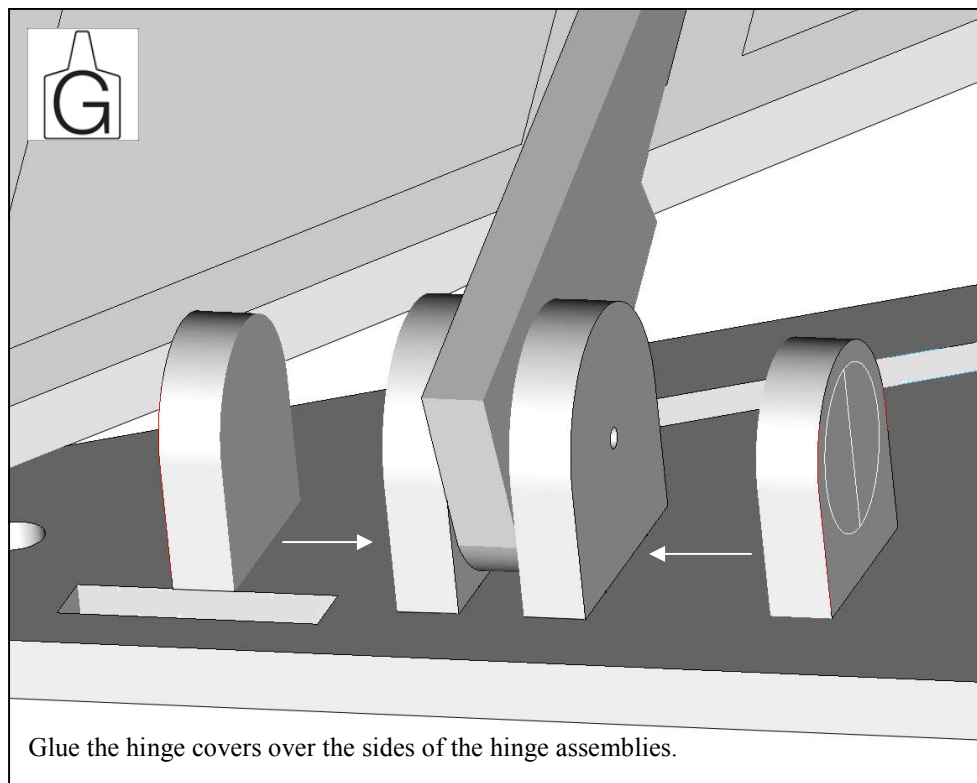

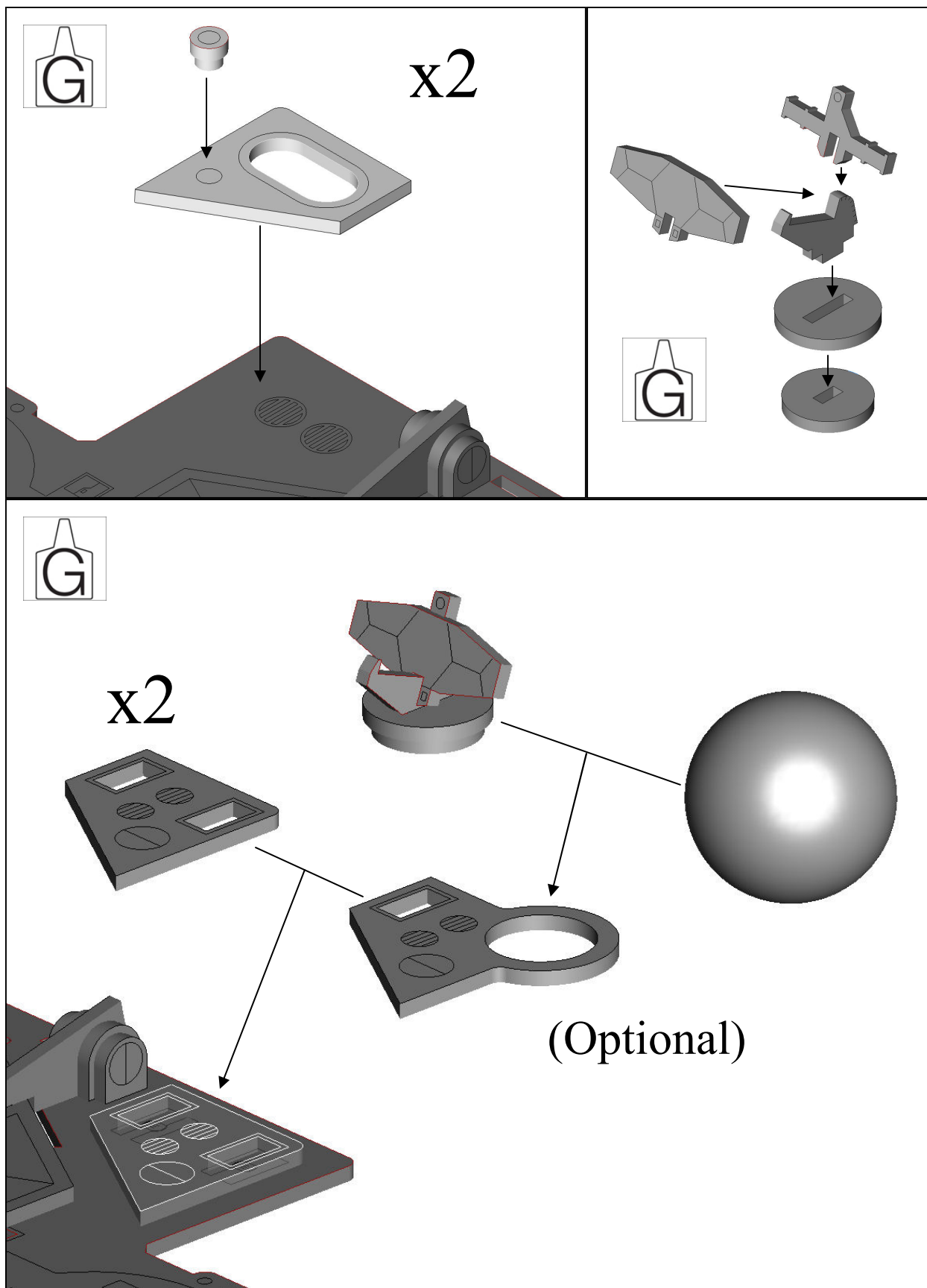

**DO NOT GLUE ANY OF
THE PARTS ON THIS PAGE
TOGETHER!**



**NOTE: Remove any protective
coatings from the mirrors before
assembly.**

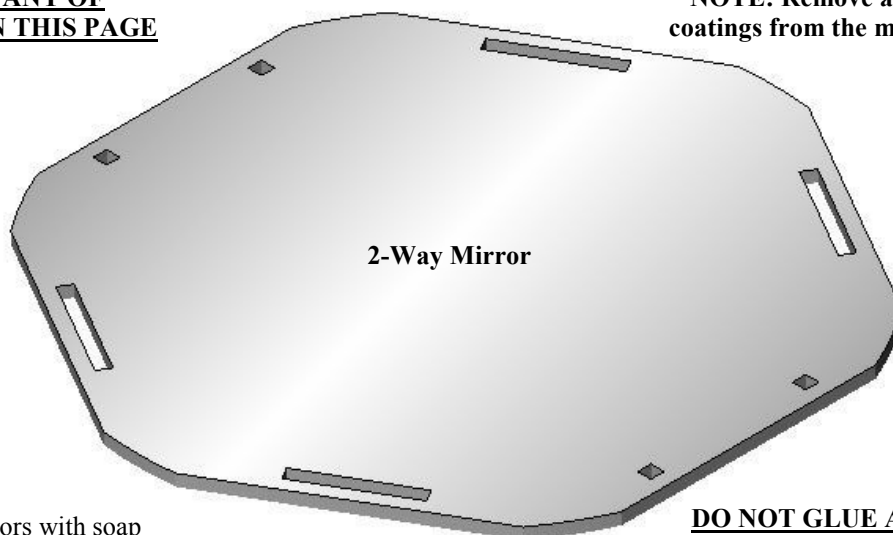

Clean the mirrors with soap
and water ONLY! Solvents
(even window cleaner!) can
cause Acrylic to cloud.

**DO NOT GLUE ANY OF
THE PARTS ON THIS
PAGE TOGETHER!**

Once installed, the outer
casing of the model will keep
this assembly together. This
allows for easy access when
cleaning the mirrors.

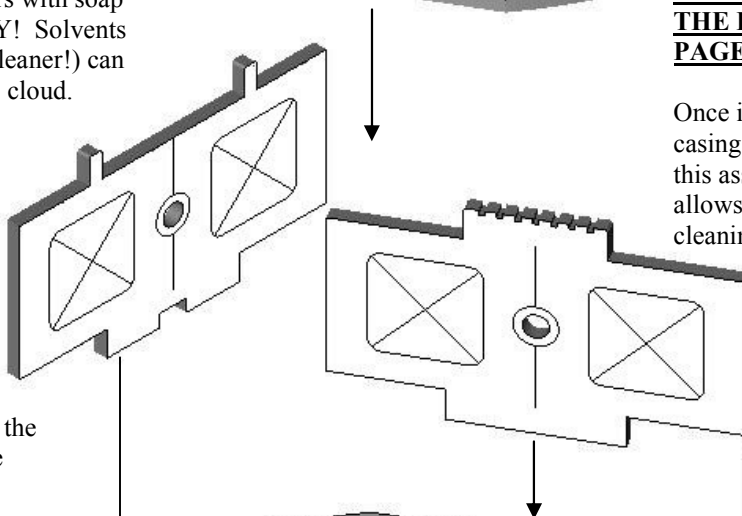

It is best to paint the
inner walls white
before assembly.

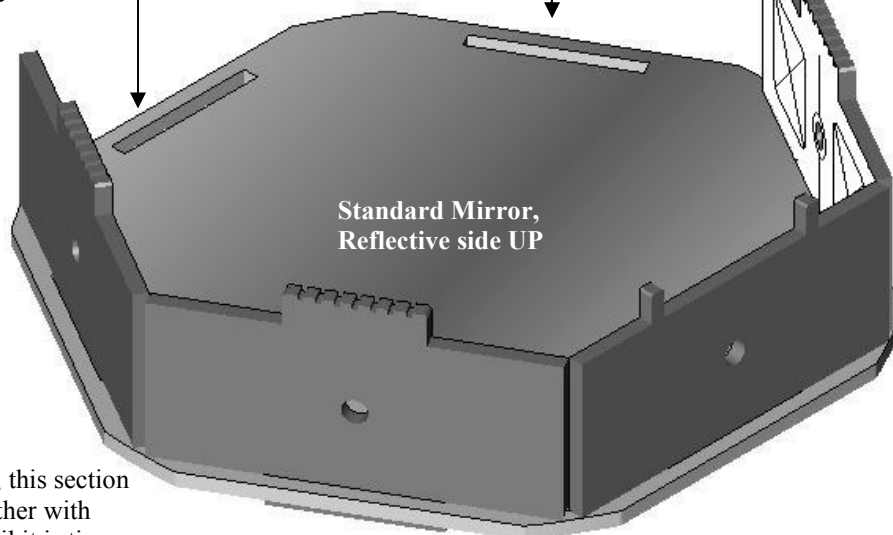

Once assembled, this section
can be held together with
rubber bands until it is time
to install it in the model.
Remove the rubber bands
before installation.



DO NOT GLUE ANY OF THE PARTS ON THIS PAGE TOGETHER!

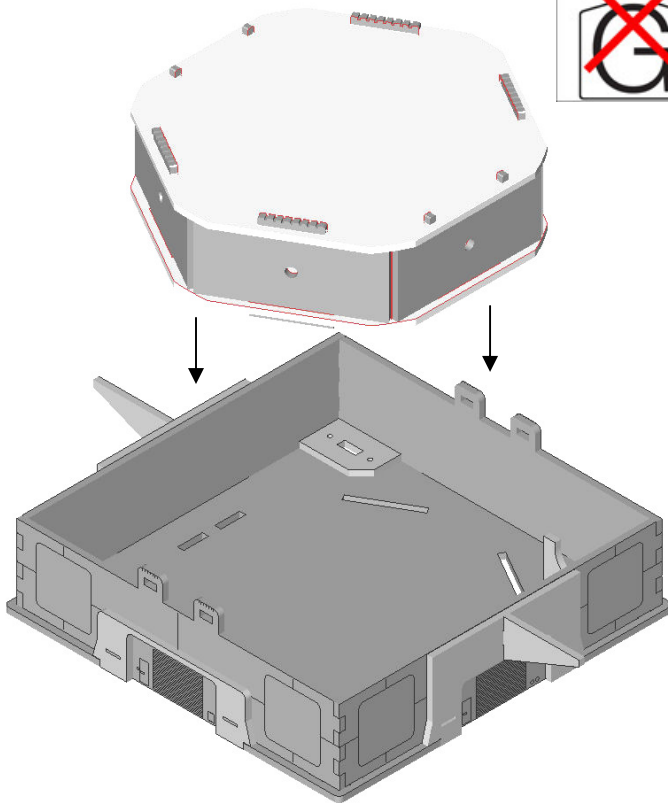

After the mirror assembly is installed in the base (left), screw the switch to the switch plate and carefully run the wiring around the mirror assembly.

Gently push the LEDs into their holes and then tack them in place with a very small dot of PVA glue.

Install the battery and test the electronics with the switch.

Once the PVA on the back of the LED lights is thoroughly dry, place the top on the model by running the latch tabs through the slots between the hinge assemblies (right).

BE CAREFUL NOT TO PINCH THE WIRING BETWEEN THE SECTIONS!

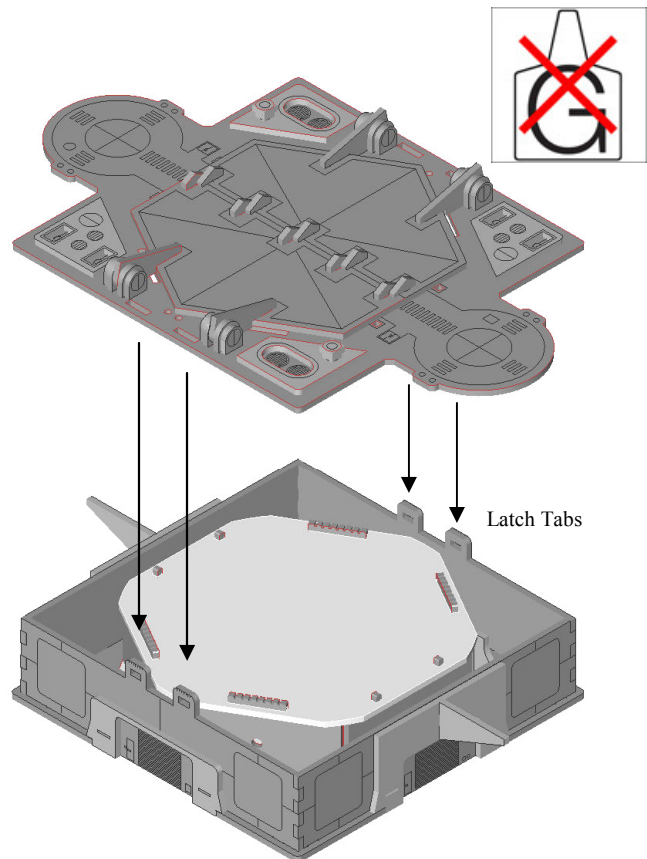

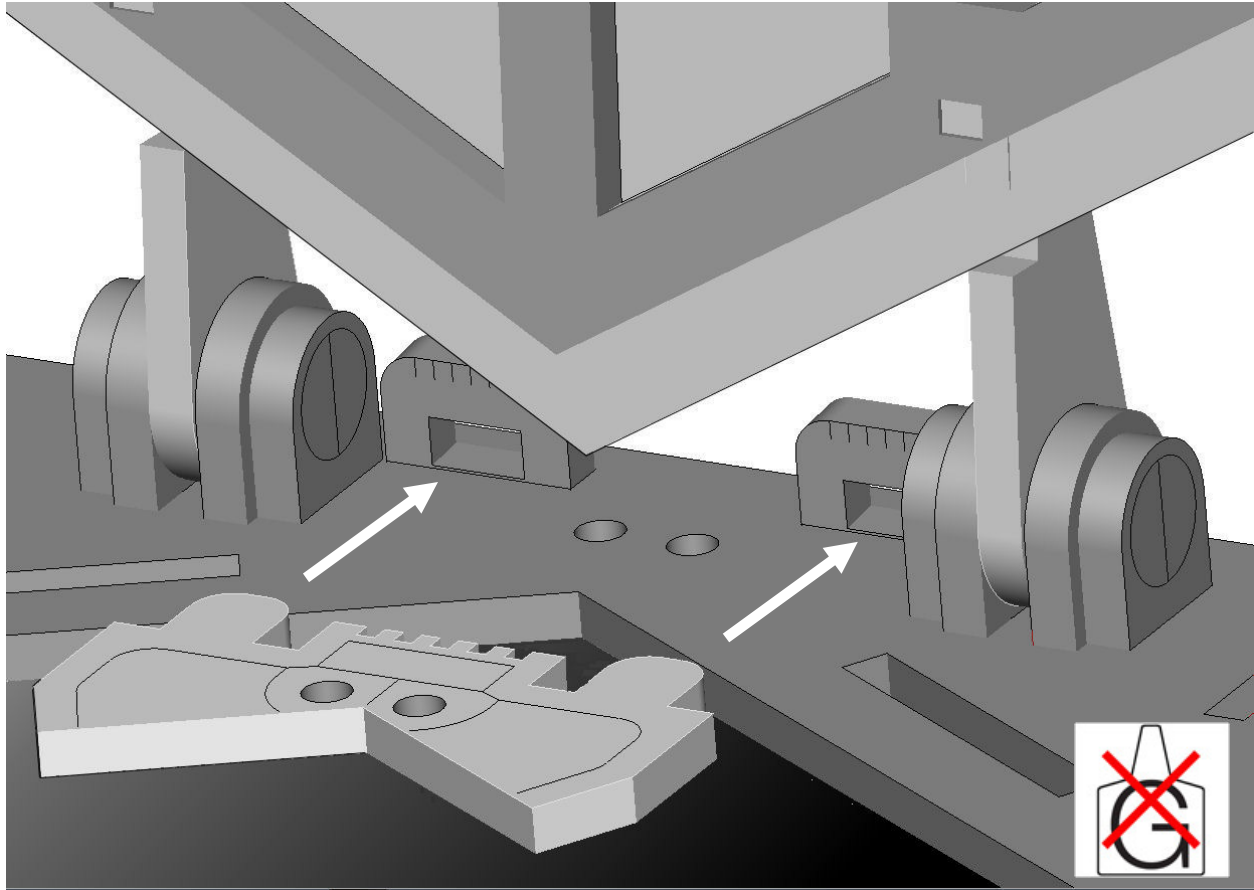

To secure the top to the base of the model, open the doors and slide the latch pins in place (above). Sanding the sides of the latch pins may be necessary. Closing the doors will keep the latch pins in place. **DO NOT GLUE THE LATCH PINS IN PLACE!**

To open the model for cleaning or to change the battery, open the doors, slide the latch pins out, and lift off the top.

IMPORTANT: Do Not use spray paint on the sensor dome (ping pong ball) as it may melt the cellulose. If you must use aerosol spray paint, thoroughly hand/airbrush the sphere first with Acrylic paint and then feel free to spray paint.